

A.M.09 Sala para lavagem de roupas
Escala: 1:25

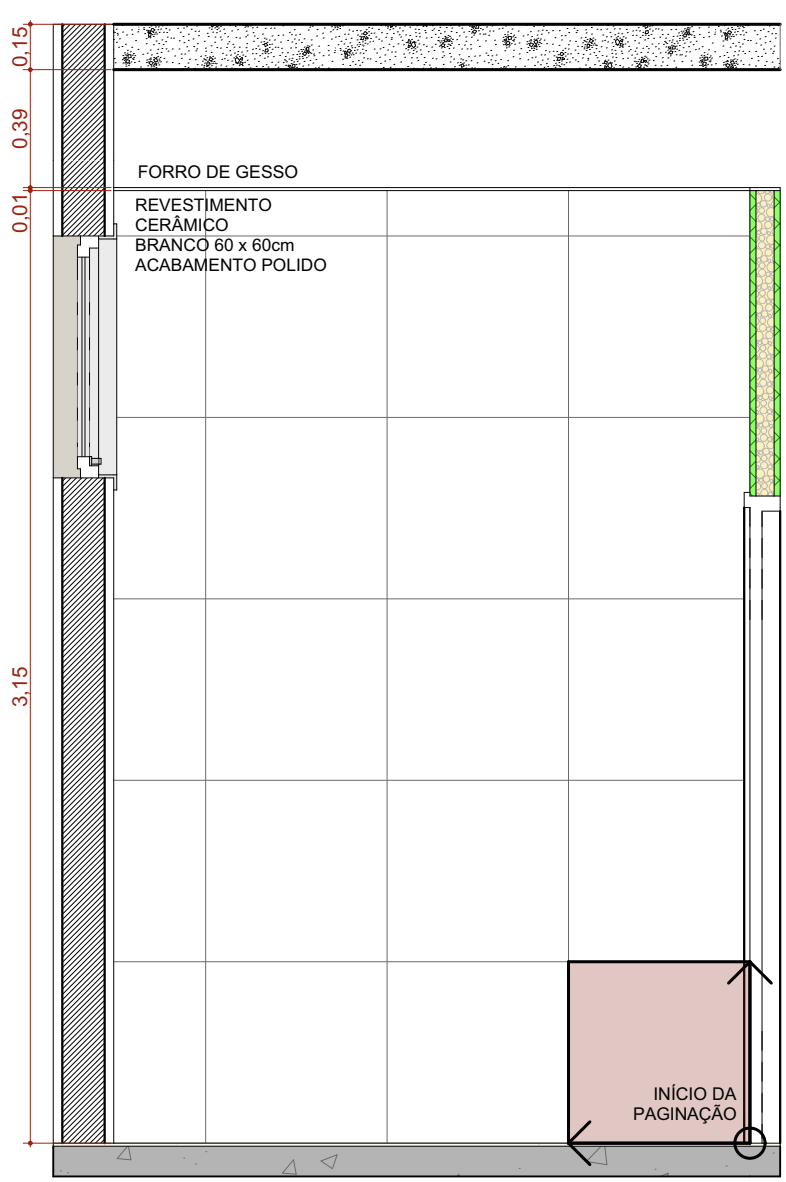

A.M.09 VISTA 01
Escala: 1:25

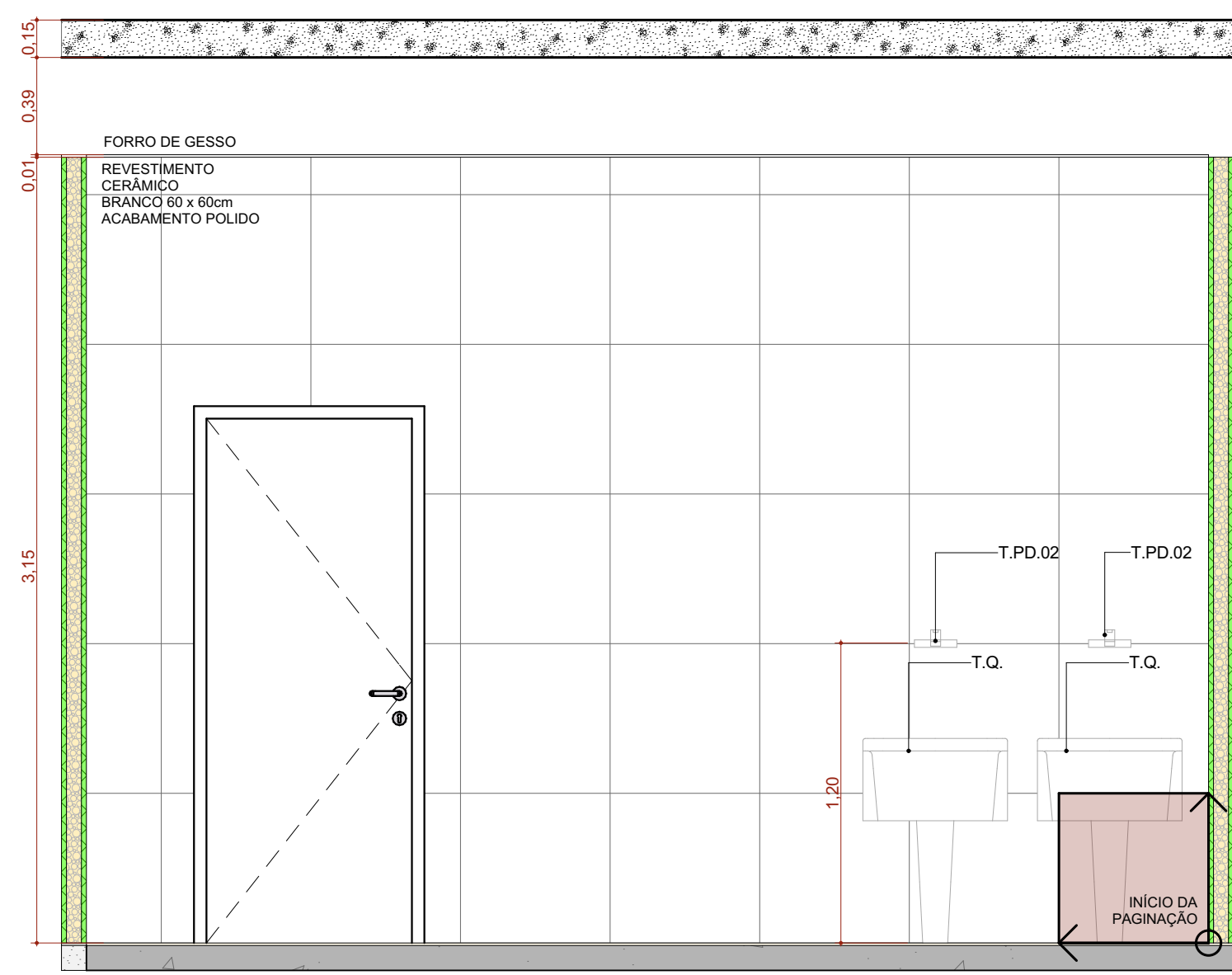

A.M.09 VISTA 02
Escala: 1:25

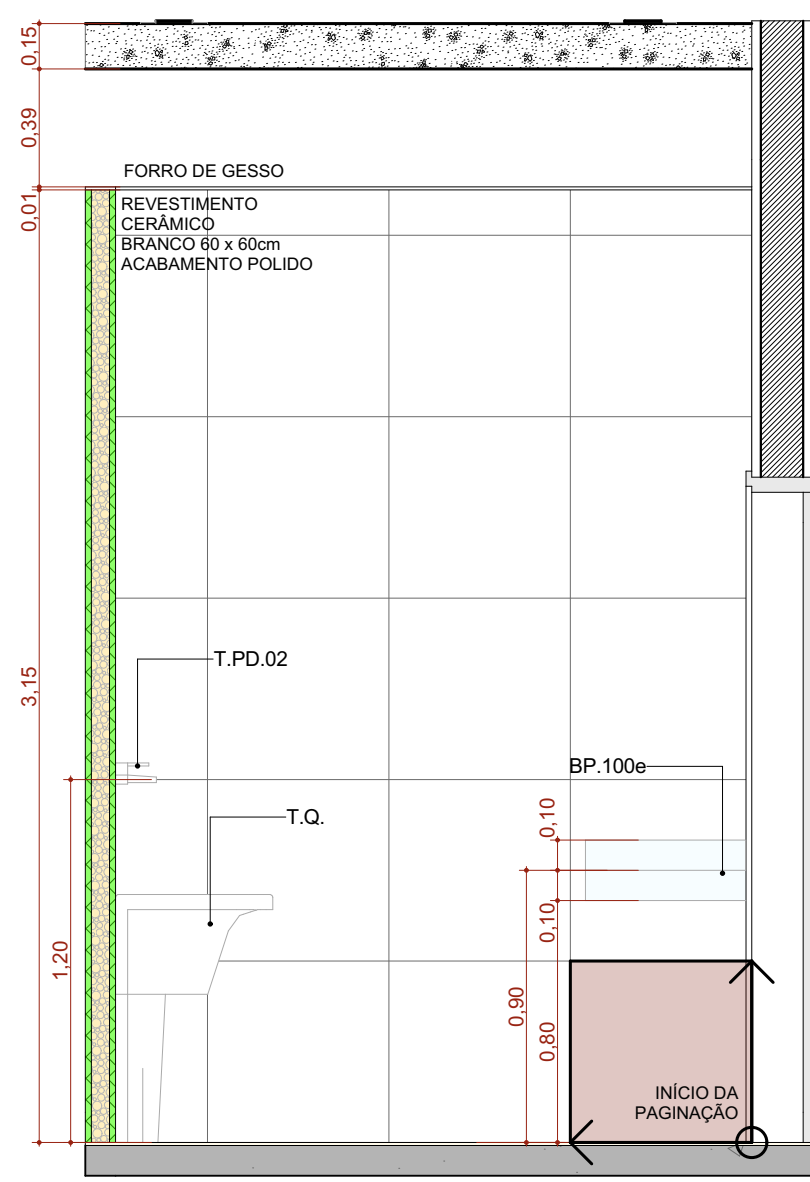

A.M.09 VISTA 03
Escala: 1:25

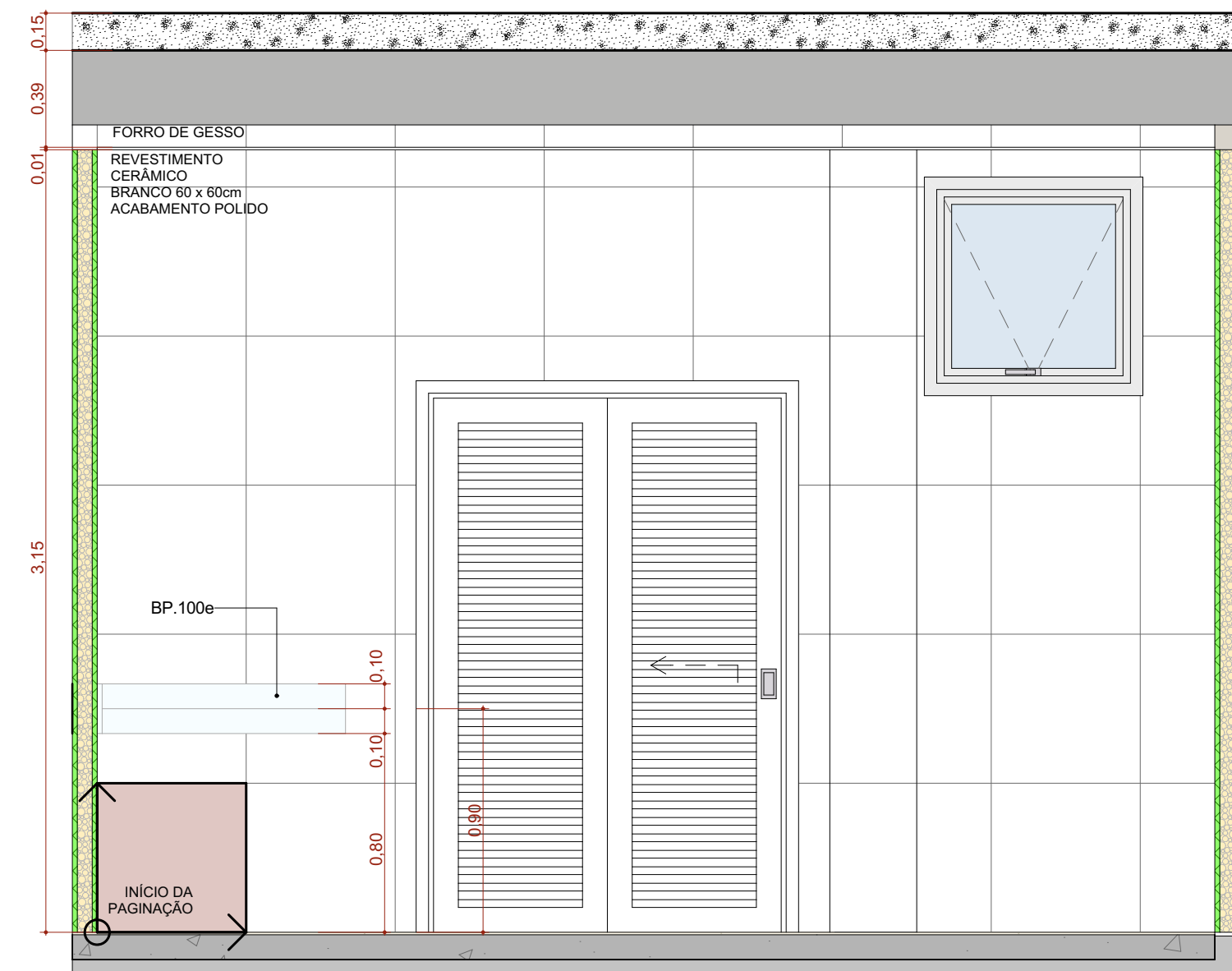

A.M.09 VISTA 04
Escala: 1:25

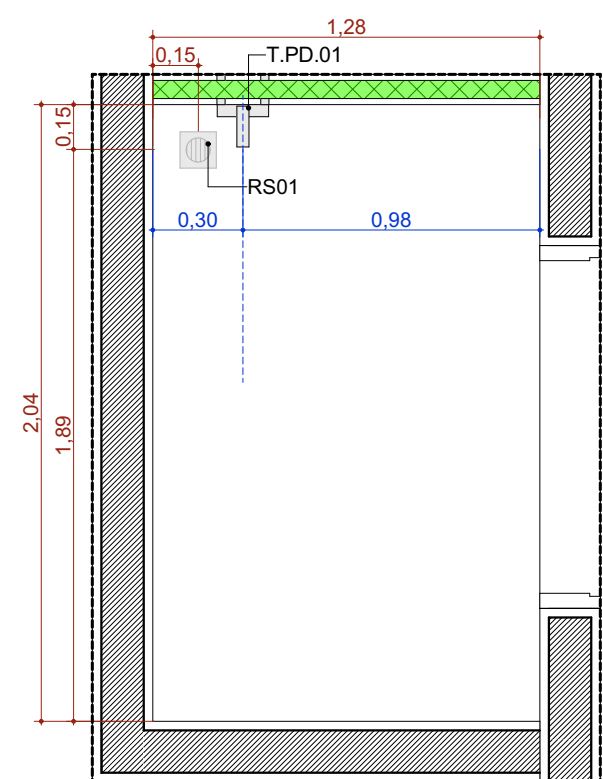

A.M.10 Abrigo de Reíduos Contaminados (Grupo A e E)
Escala: 1:25

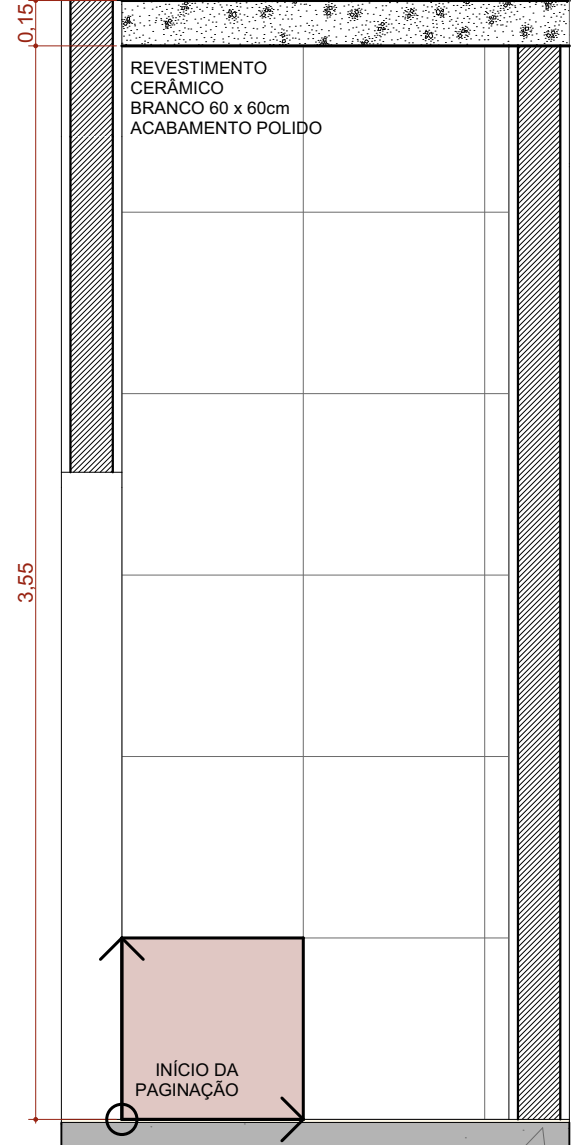

A.M.10 VISTA 01
Escala: 1:25

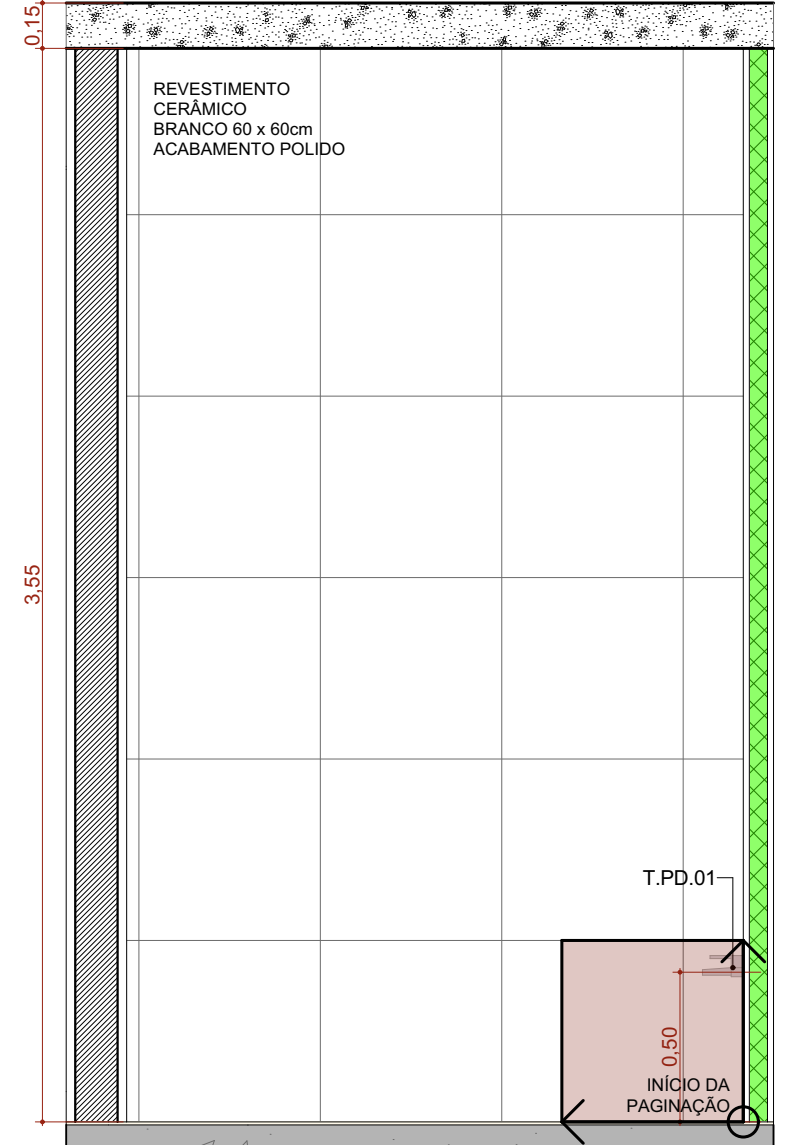

A.M.10 VISTA 02
Escala: 1:25

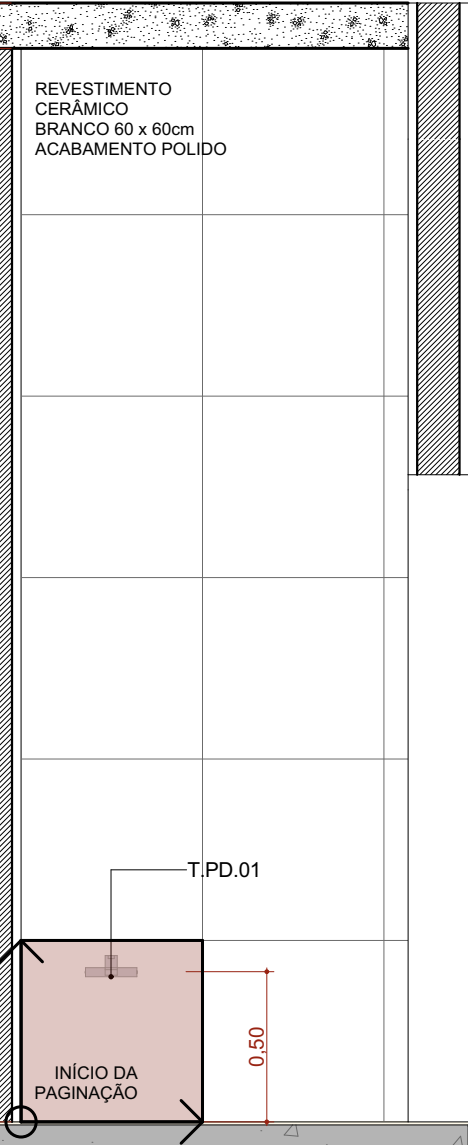

A.M.10 VISTA 03
Escala: 1:25

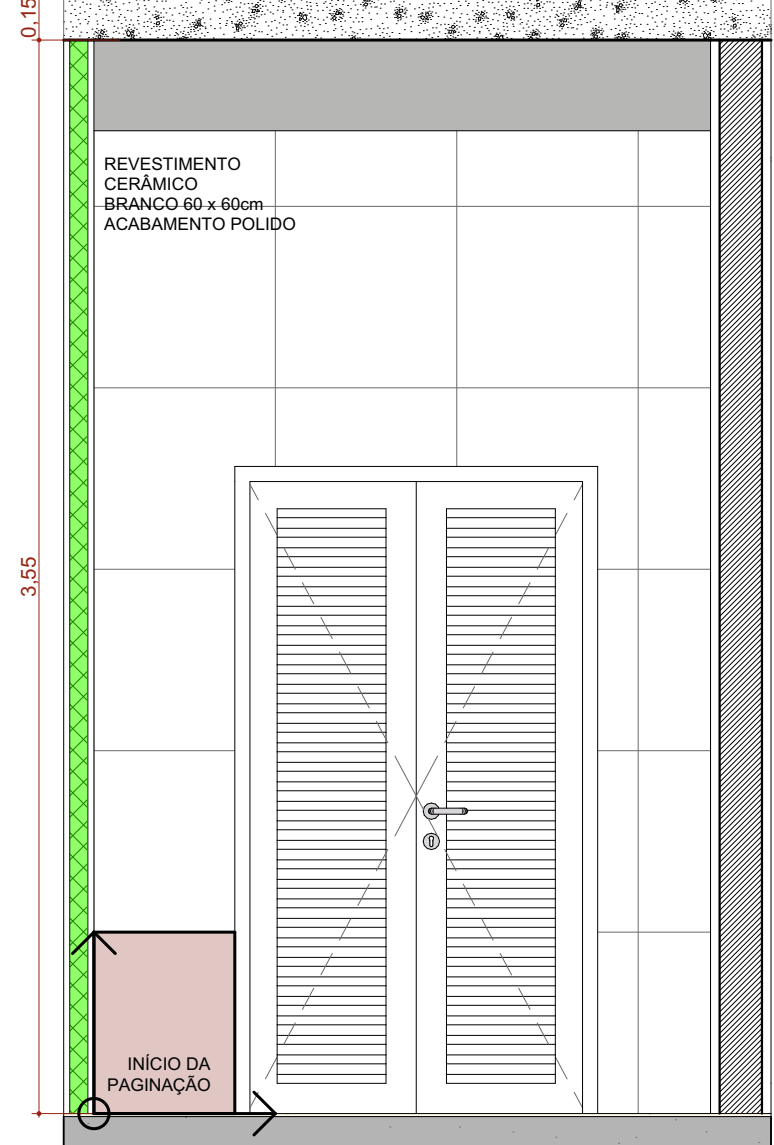

A.M.10 VISTA 04
Escala: 1:25

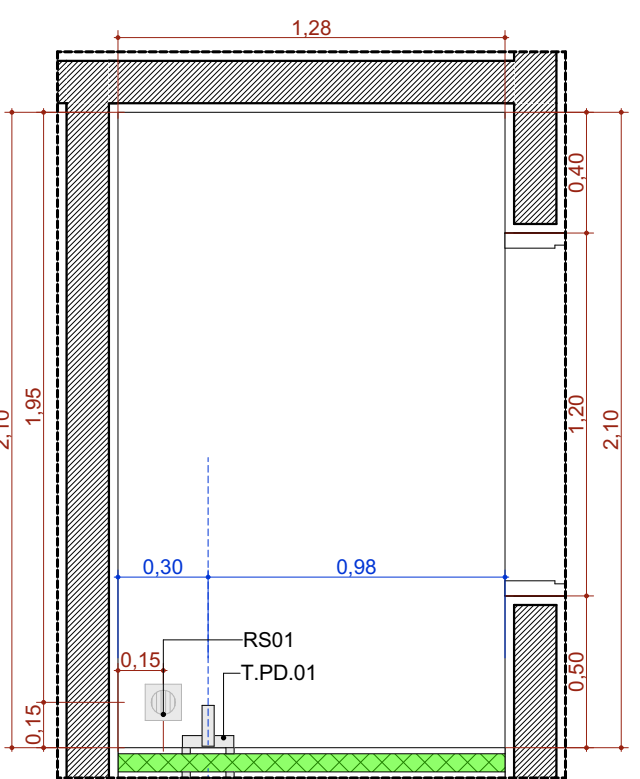

A.M.11 Abrigo de Reíduos comuns (Grupo D)
Escala: 1:25

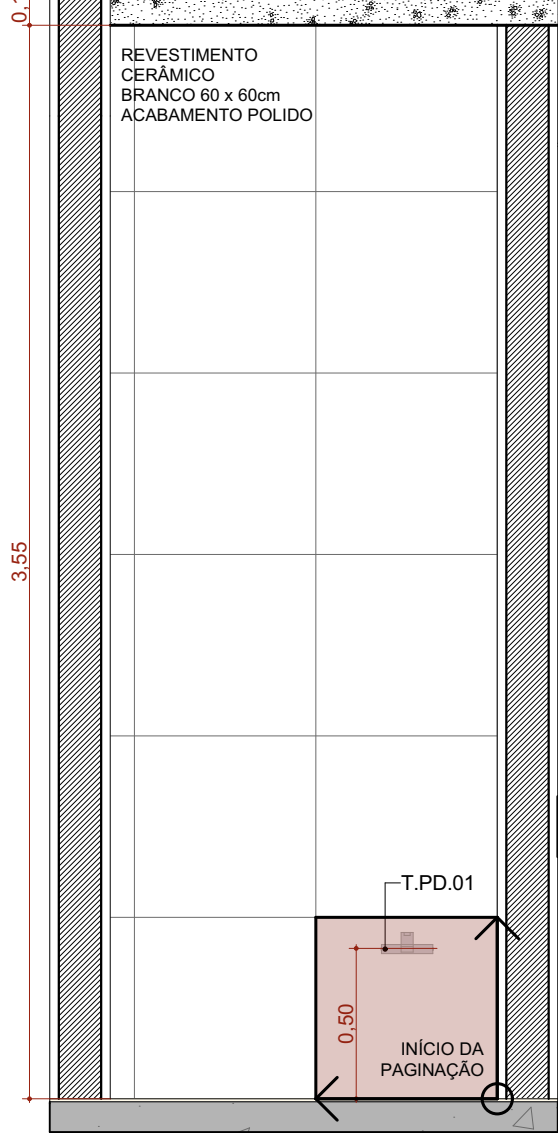

A.M.11 VISTA 01
Escala: 1:25

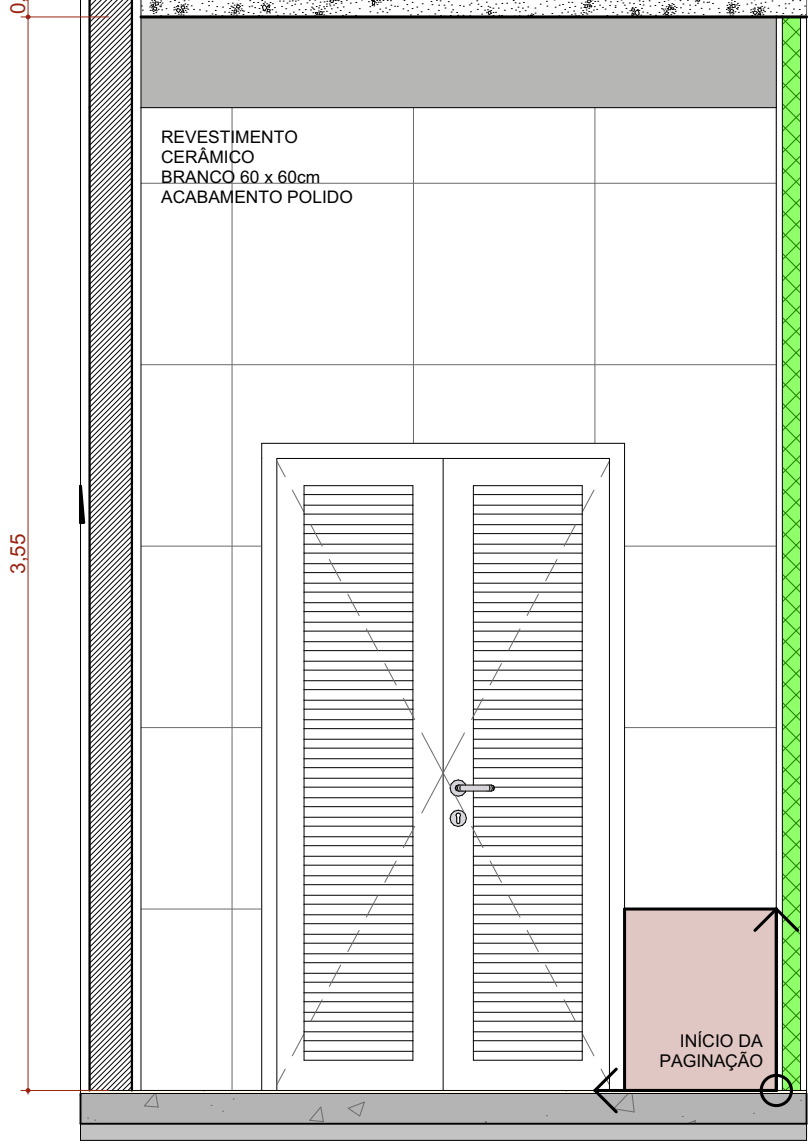

A.M.11 VISTA 02
Escala: 1:25

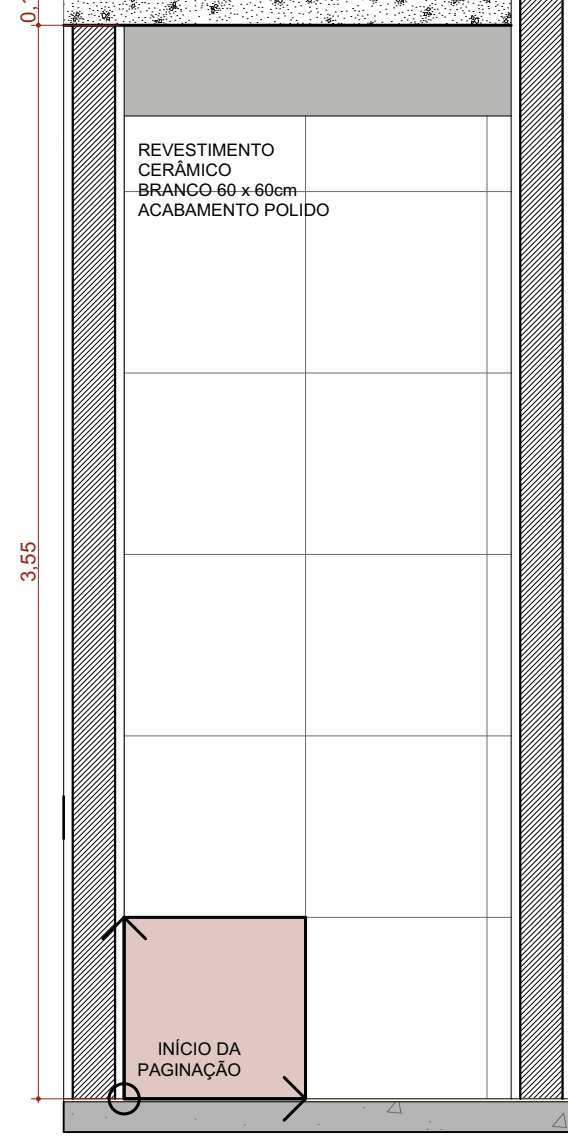

A.M.11 VISTA 03
Escala: 1:25

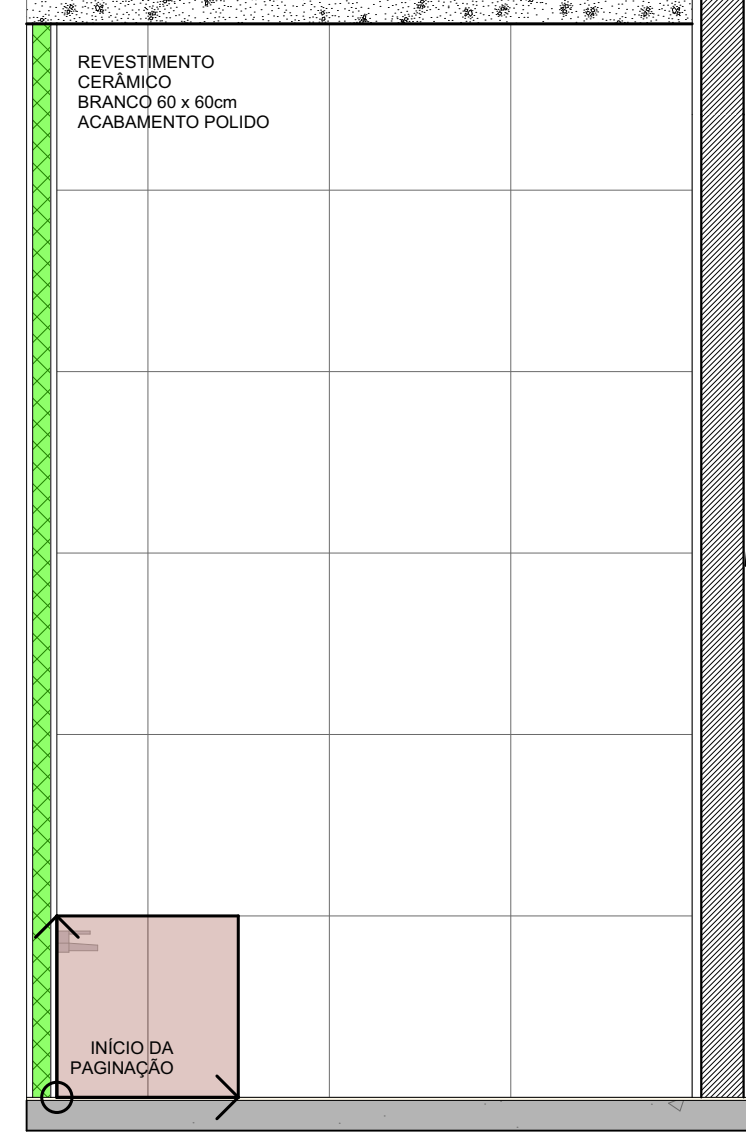

A.M.11 VISTA 04
Escala: 1:25

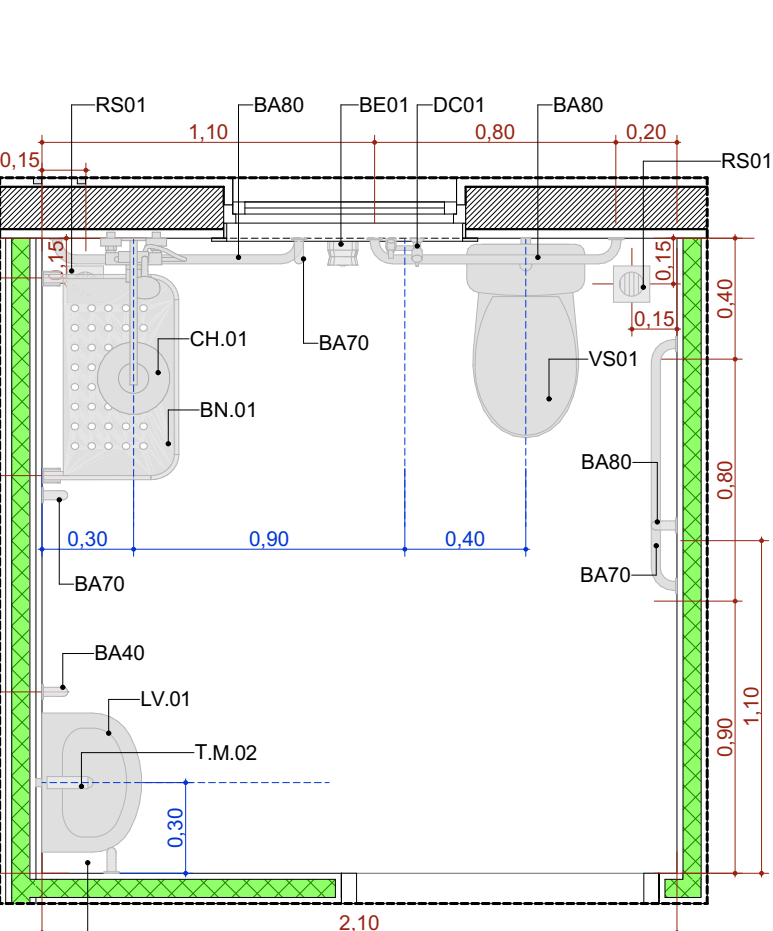

A.M.12 Banheiro
Escala: 1:25

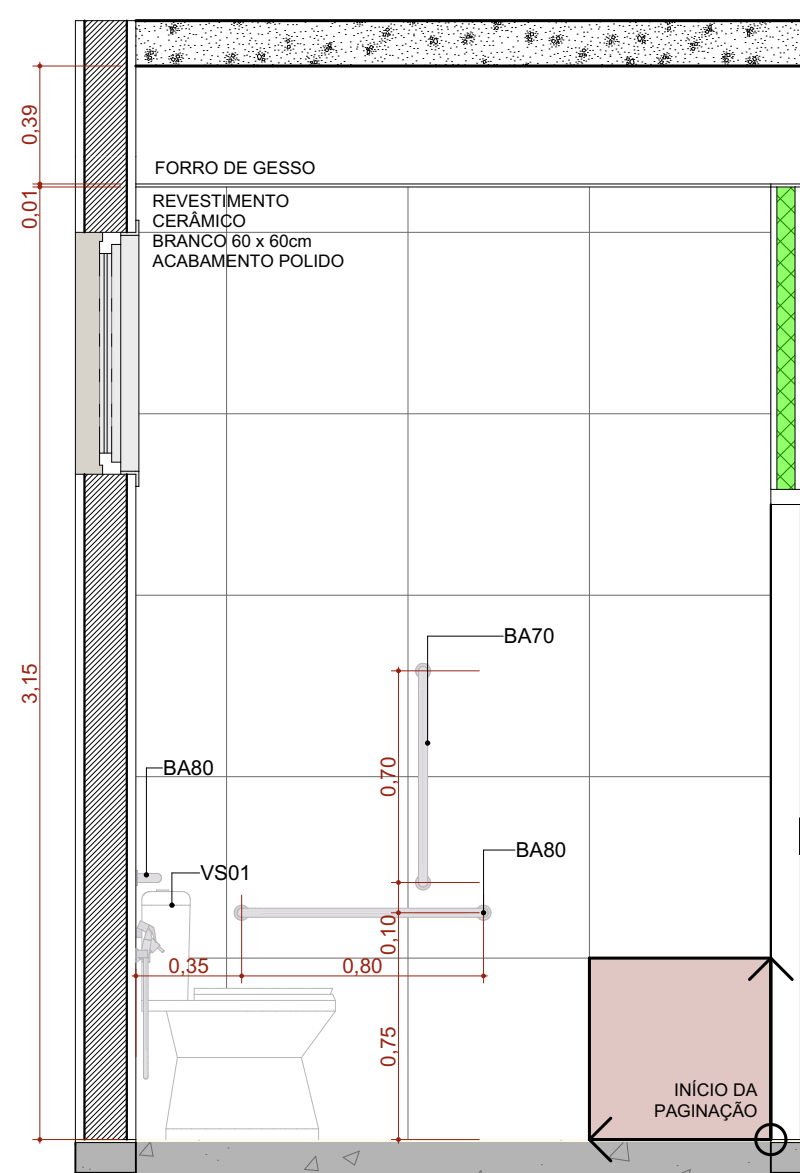

A.M.12 VISTA 01
Escala: 1:25

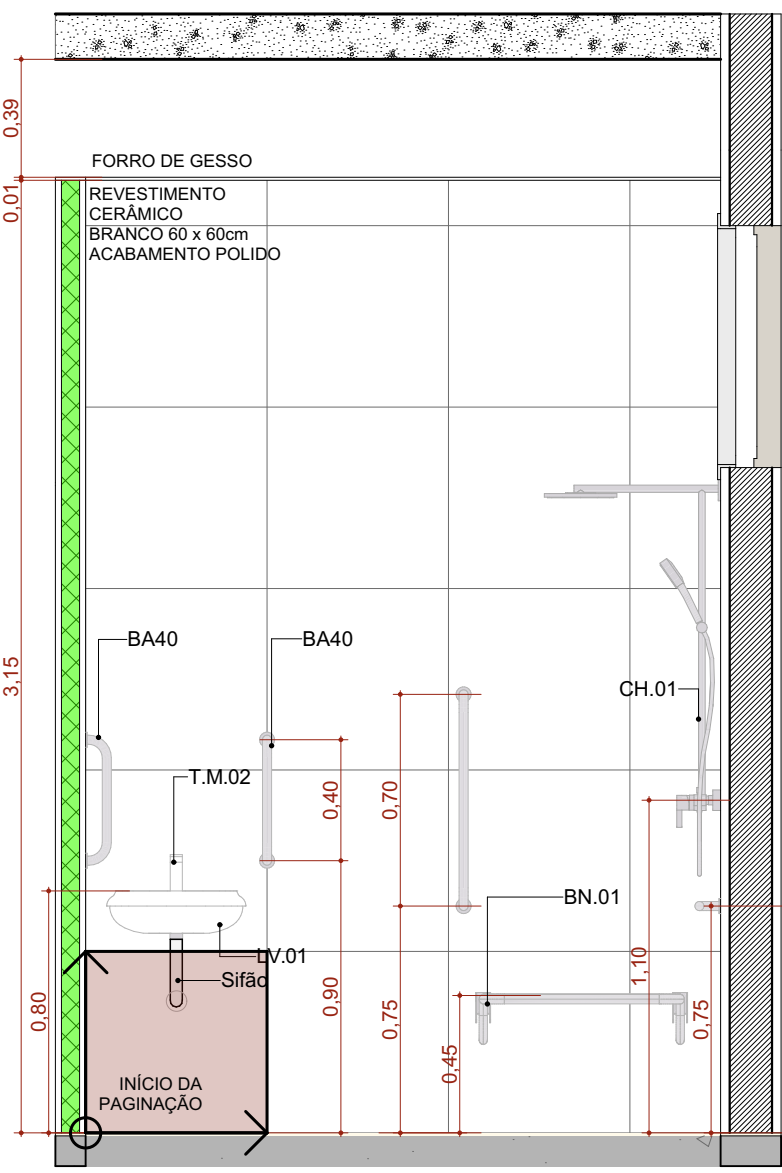

A.M.12 VISTA 02
Escala: 1:25

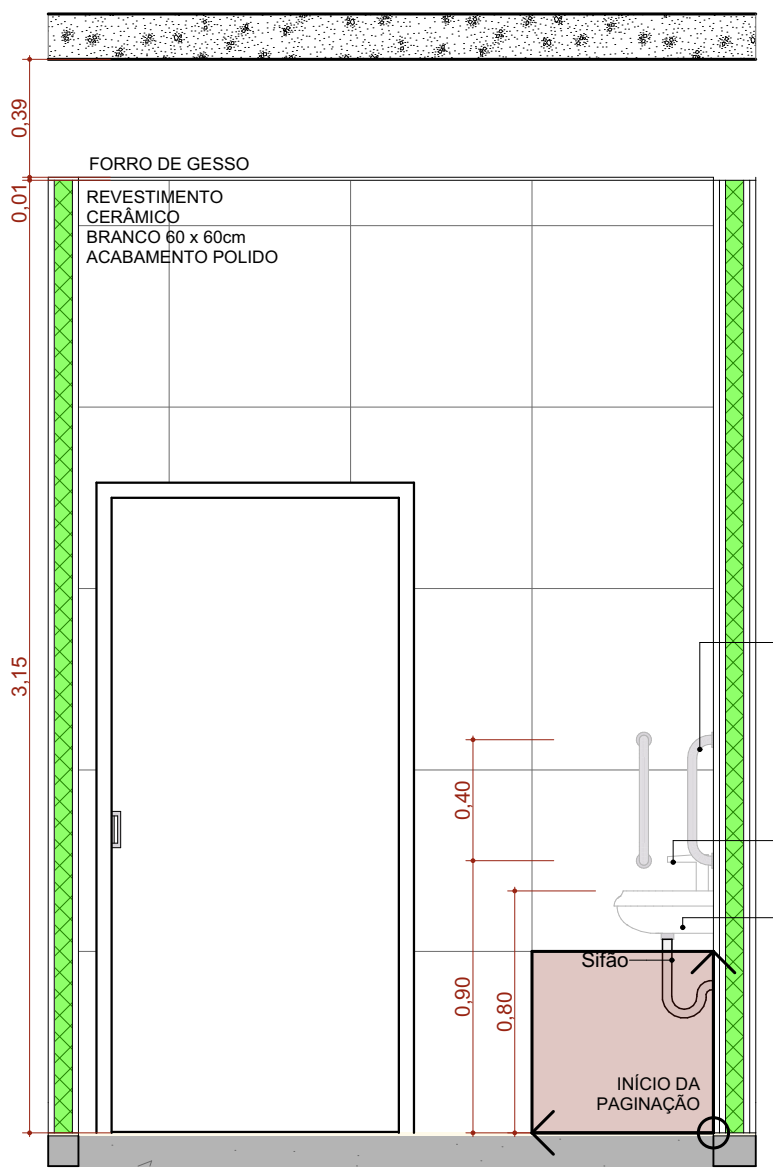

A.M.12 VISTA 03
Escala: 1:25

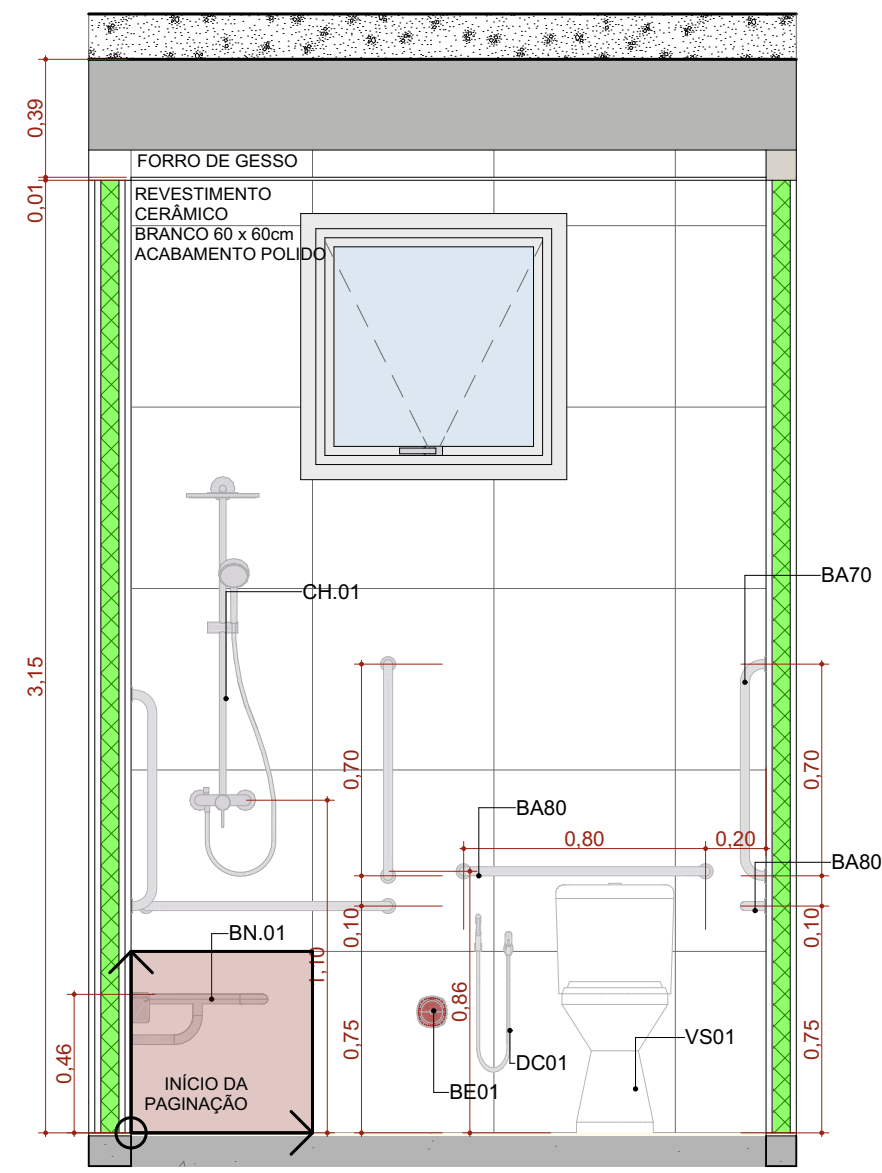

A.M.12 VISTA 04
Escala: 1:25

ASSINATURAS E CARIMBOS DO ENTE - APROVAÇÃO E EXECUÇÃO				PLANTA CHAVE DE SITUAÇÃO
R01	09/05/2025	PADRONIZAÇÃO DAS ESQUADRIAS		
R00	17/04/2025	EMISSÃO INICIAL		
REVISÃO	DATA	DESCRIÇÃO		
TÍTULO DO PROJETO				
CENTRO DE ATENÇÃO PSICOSSOCIAL I e II				
PROPRIETÁRIO				
MINISTÉRIO DA SAÚDE				
SECRETARIA DE ATENÇÃO ESPECIALIZADA À SAÚDE				
CNPJ				
00.394.544/0109-03				
ENDEREÇO				
Secretaria de Atenção Especializada à Saúde				
Esplanada dos Ministérios Bloco G Edifício Sede - Ministério da Saúde				
CEP 70.058-900 - Brasília- DF				
TÍTULO DO PROJETO				
DETALHAMENTO ÁREAS MOLHADAS 03				
DESCRIÇÃO DA TÍTULO				
PROJETO REFERENCIAL CONCEITUAL				
NOVO PROJETO - PROJETO	REVISÃO	UNIDADE	DATA	ESCALA
CAPS I e II - FL. 13.13	R01	METROS	09/05/2025	INDICADA
MIRELA PILÓN PESSATTI			A 25660-2	
VICTORIA ANGELI CAPOVILLA			A 247156-6	
LEONARDO MENDIOT PEREIRA DOS SANTOS			A 186776-6	
DANIEL NARDELLI SANTOS			A 52345-9	
AUTORIA INTELECTUAL			REDETO	
DIREITOS AUTORAIS RESERVADOS CONFORME LEGISLAÇÃO NACIONAL E INTERNACIONAL				